

D0 fuse-links gG 400/440 V~

Cat.Nos: 4 030 59/60/61/62/63/64/65/66/67/68/69



CONTENT	Page
1. Use	1
2. Range	1
3. Technical characteristics	1
4. Dimensions and weights	1
5. Accessories	2
6. Conformity	2
7. Other information.....	2

1. USE

The D0 fuse-system is installed in low voltage distribution units, where fuse-links are accessible to non trained persons and can also be replaced by them.

The system is the most modern of the screw systems and designed for 400V~/250V= networks.

The D0 fuse range includes the standardized fuse sizes D01 and D02. The range of applications for D0 fuse-links for general application is the protection of cables and power lines. They limit and cut off unacceptable overcurrents and short circuit currents up to their nominal breaking capacity. D0 fuse-links "gG" also protect equipments and installations against dynamic effects of high short circuit currents.

2. RANGE

■ 2.1 Size D01 (E14)

Rated current In (A)	Cat.Nos
2	4 030 59
4	4 030 60
6	4 030 61
10	4 030 62
13	4 030 63
16	4 030 64

■ 2.2 Size D02 (E18)

Rated current In (A)	Cat.Nos
20	4 030 65
25	4 030 66
35	4 030 67
50	4 030 68
63	4 030 69

3. TECHNICAL CHARACTERISTICS

■ 3.1 Size D01 (E14)

Cat.Nos	Rated voltage ~ (IEC)	Rated voltage = (IEC)	Power dissipation at In	Utilisation category	I.R AC (IEC)
4 030 59	400 V	250 V	1.5 W	gG	50 kA
4 030 60	400 V	250 V	1.6 W	gG	50 kA
4 030 61	400 V	250 V	1.7 W	gG	50 kA
4 030 62	400 V	250 V	1.8 W	gG	50 kA
4 030 63	400 V	250 V	2.1 W	gG	50 kA
4 030 64	400 V	250 V	2.2 W	gG	50 kA

■ 3.2 Size D02 (E18)

Cat.Nos	Rated voltage ~ (IEC)	Rated voltage = (IEC)	Power dissipation at In	Utilisation category	I.R AC (IEC)
4 030 65	400 V	250 V	2 W	gG	50 kA
4 030 66	400 V	250 V	3 W	gG	50 kA
4 030 67	400 V	250 V	3.9 W	gG	50 kA
4 030 68	400 V	250 V	4.7 W	gG	50 kA
4 030 69	400 V	250 V	5.4 W	gG	50 kA

4. DIMENSIONS AND WEIGHTS

■ 4.1 Dimensions

Size	Total height (mm)	Diameter (mm)
D01	36	11
D02	36	15

4. DIMENSIONS AND WEIGHT (continued)

■ 4.2 Weights

Cat.Nos	Weight (g)	Cat.Nos	Weight (g)
4 030 59	6.6	4 030 65	12
4 030 60	6.6	4 030 66	12
4 030 61	6.6	4 030 67	12
4 030 62	6.6	4 030 68	12
4 030 63	6.6	4 030 69	12
4 030 64	6.6		

5. ACCESSORIES

■ 5.1 Screw cap wrench Cat.No 4 030 58



■ 5.2 Locking cap for D01 E14 fuse-bases Cat.No 4 030 55



■ 5.3 Special key for locking caps Cat.No 4 030 56



■ 5.4 Adapter for Size D01 fuse-links in Size D02 bases Cat.No 4 030 57



Principle of installation of the reduction spring for D01 fuses:

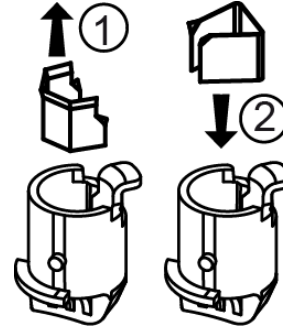

6. CONFORMITY

RoHS: Compliance with the 2011/65/EU Directive (RoHS), as modified by the 2015/863/EU Delegated Directive, on the restriction of the use of certain hazardous substances in electrical and electronic equipment.

REACH: The substances identified as SVHC (Substances of Very High Concern) according to the REACH Regulation (1907/2006), if present in the products at a concentration above 0.1% weight by weight, are declared inside the European SCIP database. At the date of publication of this document none of the substance listed in the annex XIV is found in this product.

WEEE: WEEE Directive (2012/19/EU): the sale of this product includes a contribution to the appointed environmental bodies of each European country in charge of handling, at the end of their life, the products falling within the scope of the EU Directive on Electrical and Electronic Equipment Waste.

PACKAGING: Design and manufacture of packaging compliant with European Directive 94/62/CE.

IEC 60269-3: Compliance with standards.

7. OTHER INFORMATION

For further technical information, please contact Legrand technical support.

Unless otherwise indicated, data reported in this document refers exclusively to test conditions according to product standards.