

19042000	<b>DATA SHEET</b>	
Valid from: 26.07.2024	<b>EPIC® H-B 10 TS</b>	

**Description**

- The smallest housing with single and double lever.
- The right housing is available for every application.



**General Characteristics**

Series	H-B 10
Version	Hood M20 / M25 (Article 19042100)
Locking	Bolts for double lever
Gland Body	Yes
Cable entry	Side
Protection (DIN EN 60529)	IP 65 (latched)
Protection (NEMA 250, UL50E)	4, 12 (latched)
Temperature Range	-40°C to +100°C, short term up to +125°C

**Materials and Surfaces**

Housing	Aluminium alloy, powder-coated, grey
Bolt	Heat-treatable steel, zinc-plated

**Standard**

Safety Standard	IEC 61984
-----------------	-----------

Creator: THB01/BU-EPIC Released: IVSE1/BU-EPIC	Document: DB19042000EN Version: 02	Page 1 of 2
---	---------------------------------------	-------------

19042000	<b>DATA SHEET</b>	
Valid from: 26.07.2024	<b>EPIC® H-B 10 TS</b>	

## Technical Drawings

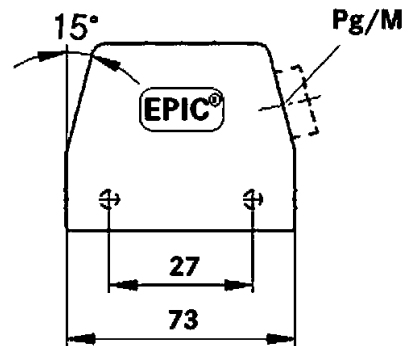
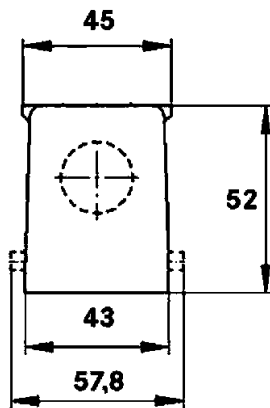

Automation



Industrial machinery and plant engineering



Mechanical resistance



Robust



Waterproof

### Info

Universal, robust metal housings size H-B 10

### Application range

Plant engineering  
Light & sound technology  
Plastics industry

### Remark

Photographs are not to scale and do not represent detailed images of the respective products.

Creator: THB01/BU-EPIC Released: IVSE1/BU-EPIC	Document: DB19042000EN Version: 02	Page 2 of 2
---	---------------------------------------	-------------